

SCHEDULE "A" SHEET 1

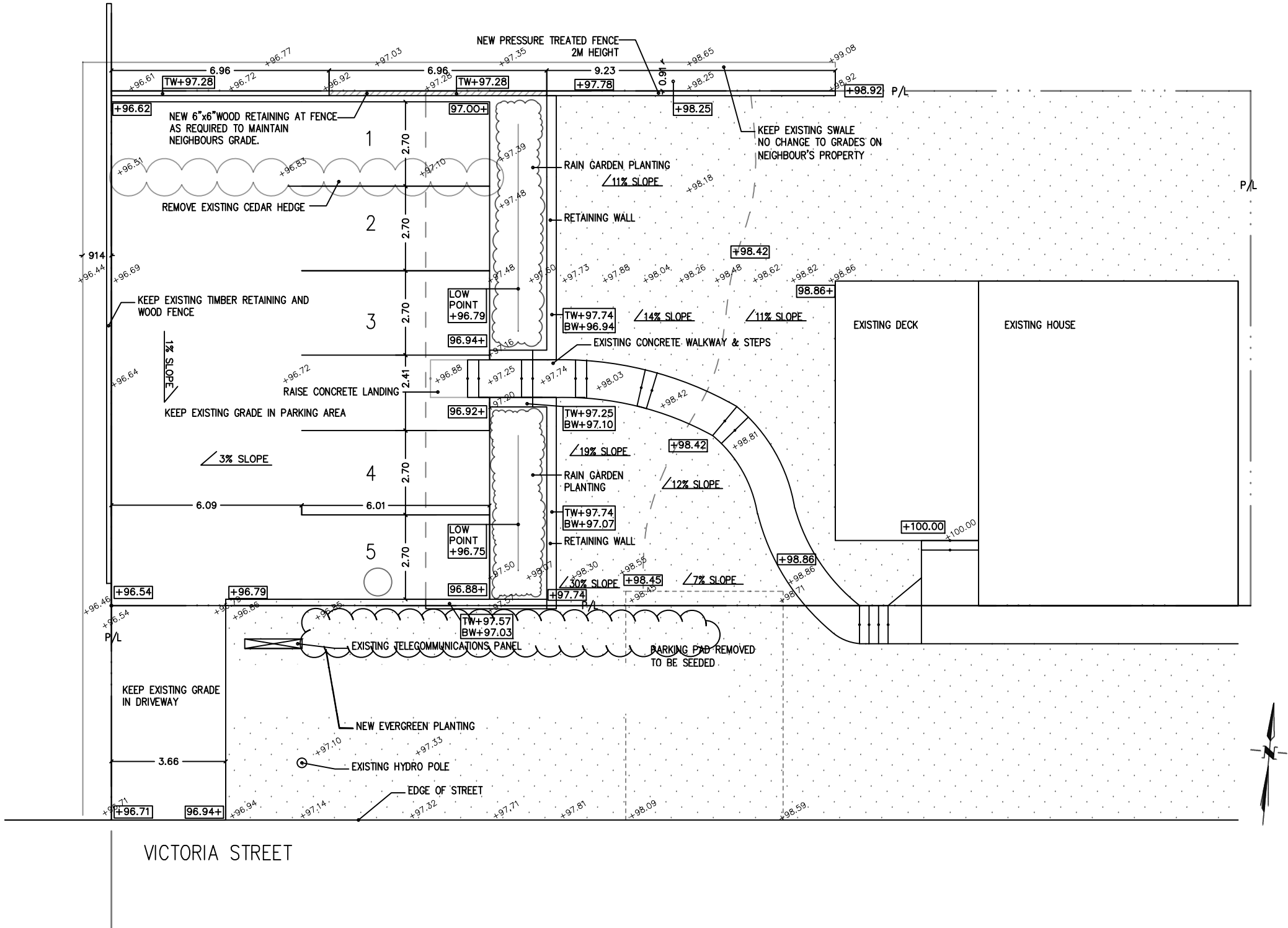

- GENERAL NOTES:
- Contractor to verify all dimensions and site conditions, and report any discrepancies to the Landscape Architect.
 - All works are to be laid out and staked for review and approval by the Landscape Architect before proceeding with construction.
 - Construction shall be undertaken to prevent damage to adjacent property. The contractor is responsible for damages on public or private property due to his own forces.
 - Contractor is responsible to ensure that waterproofing protection, insulation, and drains are in position, undamaged and uncontaminated, and to protect membrane from damage during construction.
 - Drawings are not to be scaled.
 - It is the responsibility of the contractor to ensure that separate conduits, adequate for both irrigation and landscape lighting are installed and marked during landscape construction, allowing access to all soft landscape areas on site.
 - It is the responsibility of the contractor to ensure the cleanliness of the site and structures to the satisfaction of the of the consultant. Maintain work in a neat and orderly condition at all times.
- GRADING NOTES
- Existing grades are to remain unaltered at the base of all trees to be preserved.
 - All grading and landscape construction shall be undertaken to ensure positive drainage away from buildings. Slope rough grades and finished grades away from buildings at 2% minimum. Paved surfaces are not to exceed 4% unless otherwise indicated.
 - Meet and watch all existing grades at property boundaries roadway and drainage ditches.

LEGEND:

× 100.00 EXISTING GRADE

100.00 PROPOSED GRADE

LAWN

PLANT GROUPINGS

PLANTING BED

0 1 2 3 4 5
SCALE, METRIC

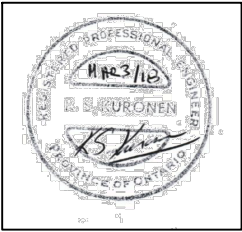

2	MAR03/18	Stamped by engineer	SDB	KK
1	JAN 27/18	For Submission	SDB	SDB
No.	Date	Description	By	Chk

project:
256 CHURCH STREET
ST. MARYS, ON.

title:
LANDSCAPE PLAN

scale: 1:150 (11x17 sheet)	date: 01/27/2018
drawn/chk: sdb	sheet: L-1